

Tractor unit exterior display 201 series

Truck-Tech UK
On-board weighing - load management systems

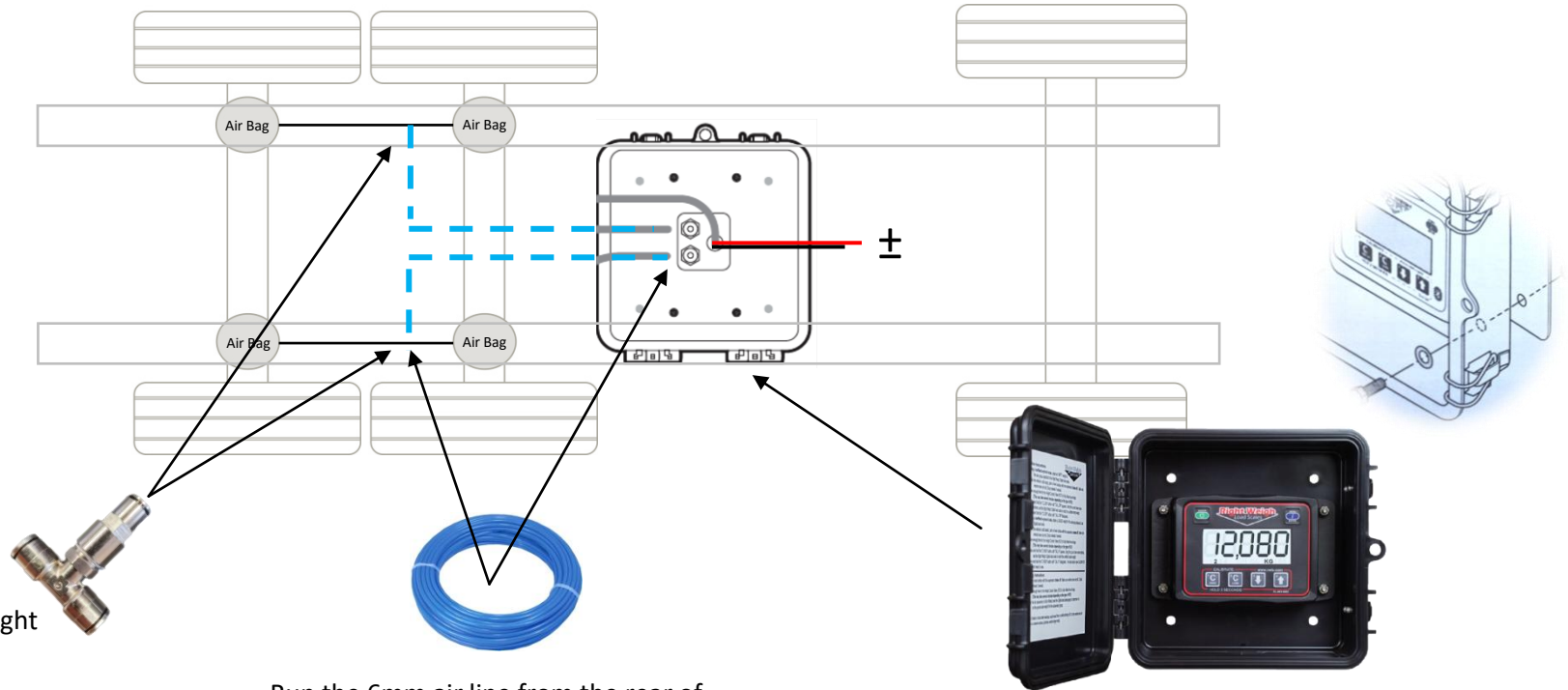

Dual levelling Valve Tractor unit



Insert Tee pieces into left and right side of air suspension.

Run the 6mm air line from the rear of the display to the Tee pieces.

Attach external scale to rear of unit.

External trailer display 201 series

Truck-Tech UK

On-board weighing - load management systems

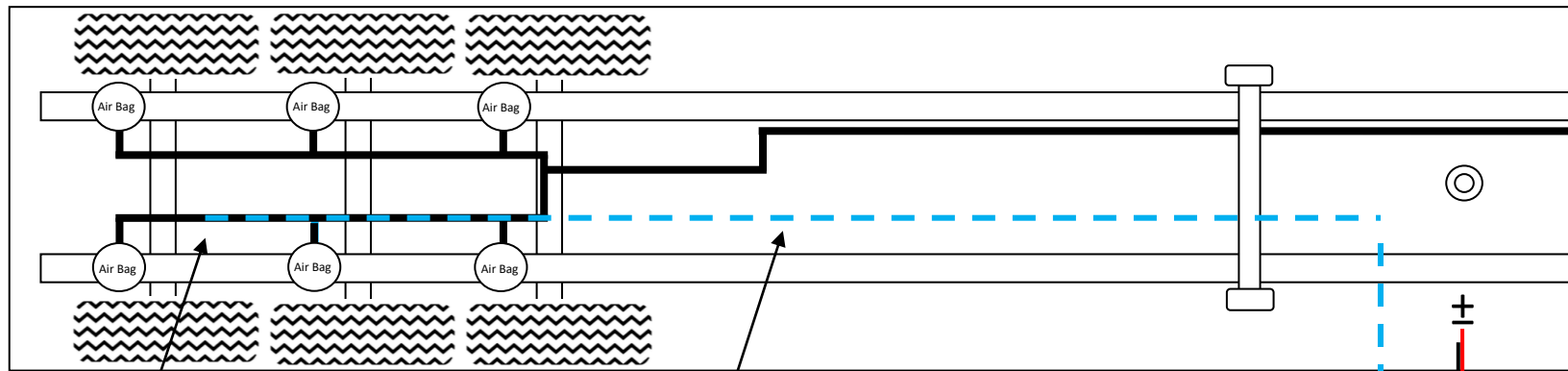

Insert Tee into suspension airline.
(avoid lift axle)

Run 6mm sensor airline to the Tee piece.

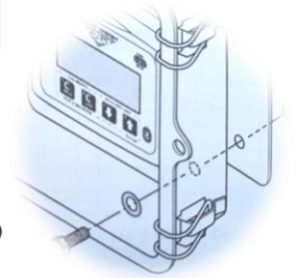

Attach the external display to the trailer.